

Clock-controlled Programme

set up own program:if the factory setting(P1...P6)programs could not satisfied by the user's requirement which can modify the P7 as own program setting.

- Operation method:
- 1)Press menu key 5 sec in normal working condition till enter the event mode and choose P7.
 - 2)At this time,Press (←) key 5 sec till enter the own program setting.
 - 3)Press (←) key again to choose the program date.
 - 4)Press menu key to change the current day anti-frozen mode and program mode.
 - 5)The symbol of temperature sensor under the program mode will change to "0...24" event.

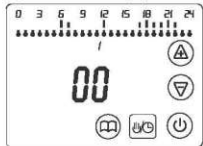

- 6)Press (→) key one time to enter to comfort temperature(high temp.)
- Press (→) key once more to confirm to enter to next programming event
- 7)Press (→)key one time to enter to energy-saving temperature(low temp.)
- Press (→)key once more to enter to next programming event.
- 8)Press (←)key again to enter next day programme set

Application I: Apply to E8.2RF thermostat(wireless)mode



Application II: E8.2RF wireless thermostat many-to-one,which applies to temperature controls for separate room.

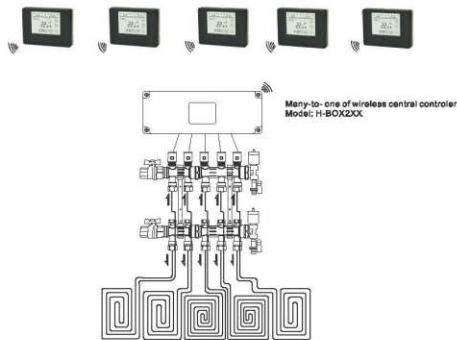

Mounting

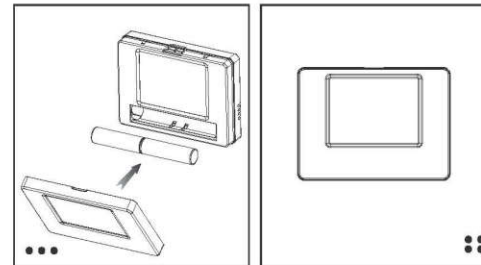
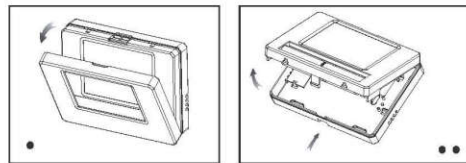

E8.2RF Room Thermostat Controller



One Pair Size AA batteries/Radio Frequency Underfloor Heating

Feature

- Radio frequency 433MHz,one-to-one or many-to-one, a variety of solutions.
- A potential-free connected controlling port.
- Special for underfloor heating or boiler heating.
- Two section size AA batteries to ensure the power of one heating season.
- Adopt magnetic latching relay/low power consumption.
- 24 events every day,7-day programmable controller.
- Energy-saving temperature and comfort temperature selectable
- Parameter memory,anti-frozen function
- Key-lock function,low battery indicator.
- Touch screen thermostat,fashion AL-MG alloy or plastic coving
- Large LCD screen with white backlight.
- Wall surface mounted



